

**WHEEL BASED VEHICLE RESTRAINT**

- ▶ Universal Wheel Chock with Light Communication System
- ▶ Audible Alerts to Ensure Safe Use and Storage
- ▶ Interior Messages for the Position of the Chock
- ▶ iDock® Alert with Interactive Message Display
- ▶ Option to Connect Online with myQ® Dock Management
- ▶ Strong Grip to Limit Sliding
- ▶ Aluminum for Strength and Light Weight
- ▶ Zinc-Plated Steel Teeth and Storage Bracket
- ▶ Replaceable Teeth for Overall Longevity
- ▶ Made in the USA

**GENERAL DESCRIPTION:** The McGuire® UniChock™ is a wheel-based trailer restraint with advanced light communication and available as a standalone unit or integrated with other dock equipment. Universally effective in most conditions, the unit helps prevent unexpected trailer departure or movement from the loading dock during the loading process. The UniChock vehicle restraint features unique zinc plated traction teeth, inside iDock control panel, exterior communication lights and instructional signs.

**CONSTRUCTION:** The restraint unit is durable and light weight aluminum with a powder coat finish. The traction teeth and storage bracket are zinc-plated steel. Wired sensors are installed in the restraint unit and the storage bracket. The control panel is NEMA 4X with all components, connections and wiring UL listed and/or recognized. Panels are built in-house in a UL-approved control panel shop.

**OPERATION:** Once a trailer is fully backed and parked in position against the dock bumpers, the yellow UniChock is removed from the storage bracket and placed under the front of one of the trailer's back tires. This will sound an audible indicator and display a message on the iDock Controller that the unit is in a safe position. The dock attendant can then proceed to open the door and deploy the leveler.

After loading is complete, the dock attendant stores the leveler and closes the overhead door, either of which must have an installed switch interlocked with the restraint. This will then sound and display indications to return the UniChock to the storage bracket.

**EXTERIOR LIGHTS:** Low profile, traffic style, red, and green LED lights are standard for communication to truck driver. A set of caution signs warns truck driver to "Back In or Pull Out On Green Light Only".

**ELECTRICAL:** The UniChock vehicle restraint is available as a stand alone unit or combined electronically in a single integrated control panel with your dock leveler selection. Interior and exterior 12 volt LED lights are powered by an integral transformer located in the control panel. Electrical control panel is a NEMA 4X enclosure.

**Please Note: Unless specifically noted on quotation, all electrical requirements, including mounting of control box, outside lights and signs, are the responsibility of others.**

**INSTALLATION:** Requires mounting of UniChock storage base, control panel, exterior lights and signs in strict accordance with McGuire's installation instructions.

**WARRANTY:** All UniChock vehicle restraints feature a full one (1) year base warranty on all structural, mechanical and electrical parts, including freight and labor charges in accordance with Systems, LLC's Standard Warranty Policy. Systems, LLC warrants all components to be free of defects in materials and workmanship, under normal use, during the warranty period. This base warranty period begins upon the completion of installation or the sixtieth (60th) day after shipment, whichever is earlier.



A Division of Systems, LLC

# UNICHOCK™ SERIES

## WHEEL BASED VEHICLE RESTRAINT

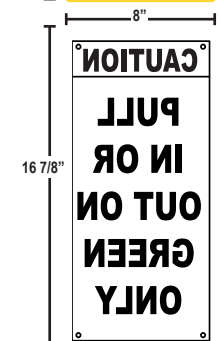
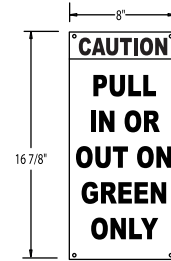
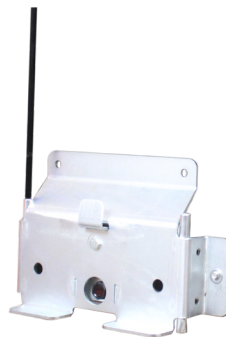
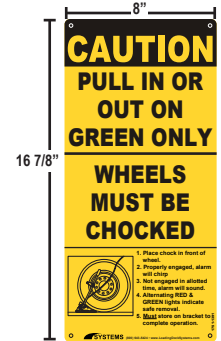
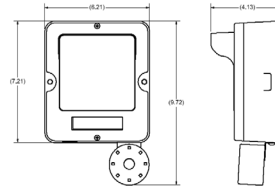

Storage Bracket

Inside signage

Outside signage

### Optional Equipment for UniChock Automatic Vehicle Restraint

Check Options Desired

- |   |   |
|---|---|
| <input type="checkbox"/> Integrated Control Panel                 | <input type="checkbox"/> Special Nema ___ Enclosure |
| <input type="checkbox"/> Restraint Engaged Interlock with Leveler | <input type="checkbox"/> Other _____                |
| <input type="checkbox"/> Restraint Engaged Interlock with Door    | <input type="checkbox"/> Other _____                |
| <input type="checkbox"/> 90° storage base                         | <input type="checkbox"/> Other _____                |

\*Options must also be selected on the iDock Controls specification sheet

Customer: \_\_\_\_\_

Job: \_\_\_\_\_

Location: \_\_\_\_\_

Number of Units: \_\_\_\_\_

Model: \_\_\_\_\_

Represented By: \_\_\_\_\_

Sales Rep: \_\_\_\_\_

Certified for Construction:

By: \_\_\_\_\_

Title: \_\_\_\_\_

Date: \_\_\_\_\_

Company: \_\_\_\_\_

City: \_\_\_\_\_

State: \_\_\_\_\_

Consistent with our policy of continuing product improvement, we reserve the right to change product specifications without notice or obligation.

McGuire • Division of Systems, LLC • W194 N11481 McCormick Dr. • P.O. Box 309 • Germantown, WI 53022  
Phone: 800.624.8473 • Fax: 262.255.9399 • www.wbmcguire.com

# VEHICLE RESTRAINT